

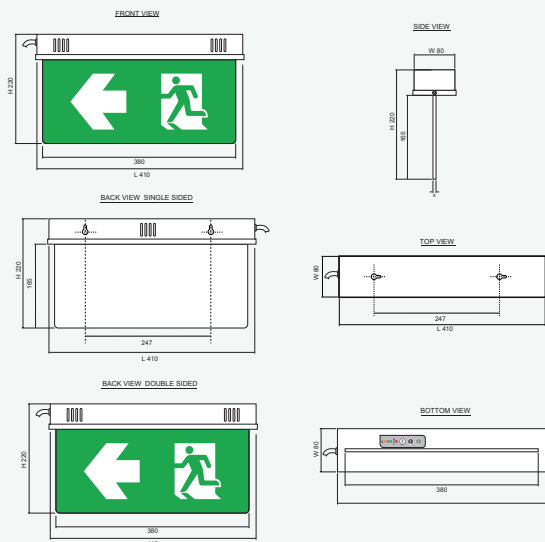

Technical Specifications

Mode of Operation	Maintained
Input Voltage	220 VAC / 50Hz \pm 10%
LED Lamp Power	10W
LED Color Temperature	6,500k - 7,000k
Battery Type / Capacity	Nickel Metal Hydride 2,100 mAh (1.2V x 3)
Charge Current (max)	0.210A
Charge Termination Voltage	1.4V/Cell
Charging Time	12 Hrs
Protections	- AC, DC Fuse - Battery Low Voltage Cut-Off
Testing System	Manual Testing
Backup Time	3.0 Hrs
Housing	Electro-galvanized steel sheet 1mm. thick with epoxy powder coating
Dimensions (LxWxH)	410 x 80 x 220 mm
Weight	1.80 Kg / Single sided 1.80 Kg / Double sided
IP Rating	20
Mounting	Surface Ceiling (Type C) / Wall (Type W)
Viewing Distance	24 M (Pictogram Height 10 CM)

Dimensions (mm)



Product Overview

The SLS2-10LED (Single sided / Double sided) emergency exit sign can be ceiling mounted and surface mounted.

The LEDs used for illumination are SMD low Power High Lumen type. It uses SMT technology that consumes 6 times less electricity than those using fluorescent bulbs with 7 times longer operational life. The quality and brightness of illumination is also certified by the Thai Industrial Standard 2430-2552 and Thailand Engineering Standard 021004-18.

The unit uses Ni-MH (Nickel Metal Hydride) batteries that are smaller but more efficient. The sign is made with clear acrylic sheet that evenly diffuses the light throughout the whole sign, even after an extended period of use.

The chassis is made with 1 mm. thick Electro-Galvanized steel sheets coated with Epoxy powder and stove enameled to help protect from any possible rust.

Features

- Uses high power LEDs rated at 10 Watts for illumination
- Having LED lifetime of over 50,000 hours
- Operate for 3.0 hours on backup time
- Automatically recharged with constant voltage and limited current
- Battery overcharge protection circuit prevents overcharge which is the cause of battery swelling
- Battery discharge protection circuit prolongs the battery life

Indicators

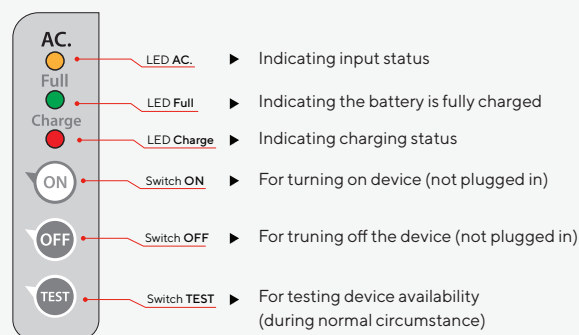

Installation

